

# versatile™ 4C Surface Mount Collar, SM16S

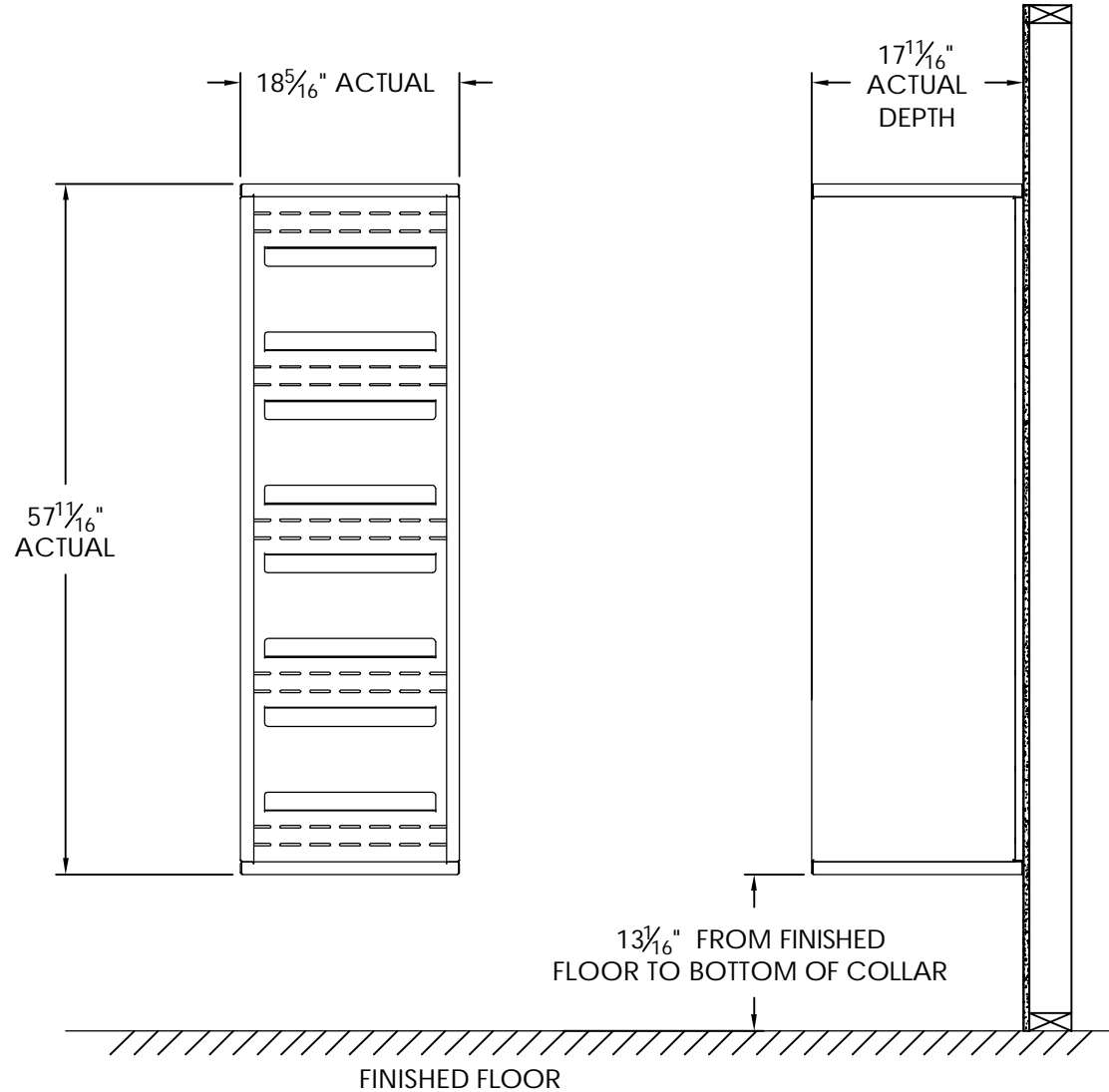

## Notes:

1. Designed to mount Florence Versatile™ 4C mailbox single column Max Height Suite modules (sold separately).
2. For use with front loading modules only.

PRODUCT SERIES: VERSATILE™ 4C SURFACE MOUNT COLLAR

**AF FLORENCE**  
manufacturing company

5935 Corporate Drive • Manhattan, KS 66503  
www.florencemailboxes.com • (800) 275-1747

A GIBRALTAR INDUSTRIES COMPANY

MODEL	SM16S	REV	C
SCALE	NONE	LAST REV DATE	7/03/2014
DRAWING NUMBER	SM16SCS	DRAWN BY	TNS

# versatile™ 4C Mailbox, 4C16S-3P

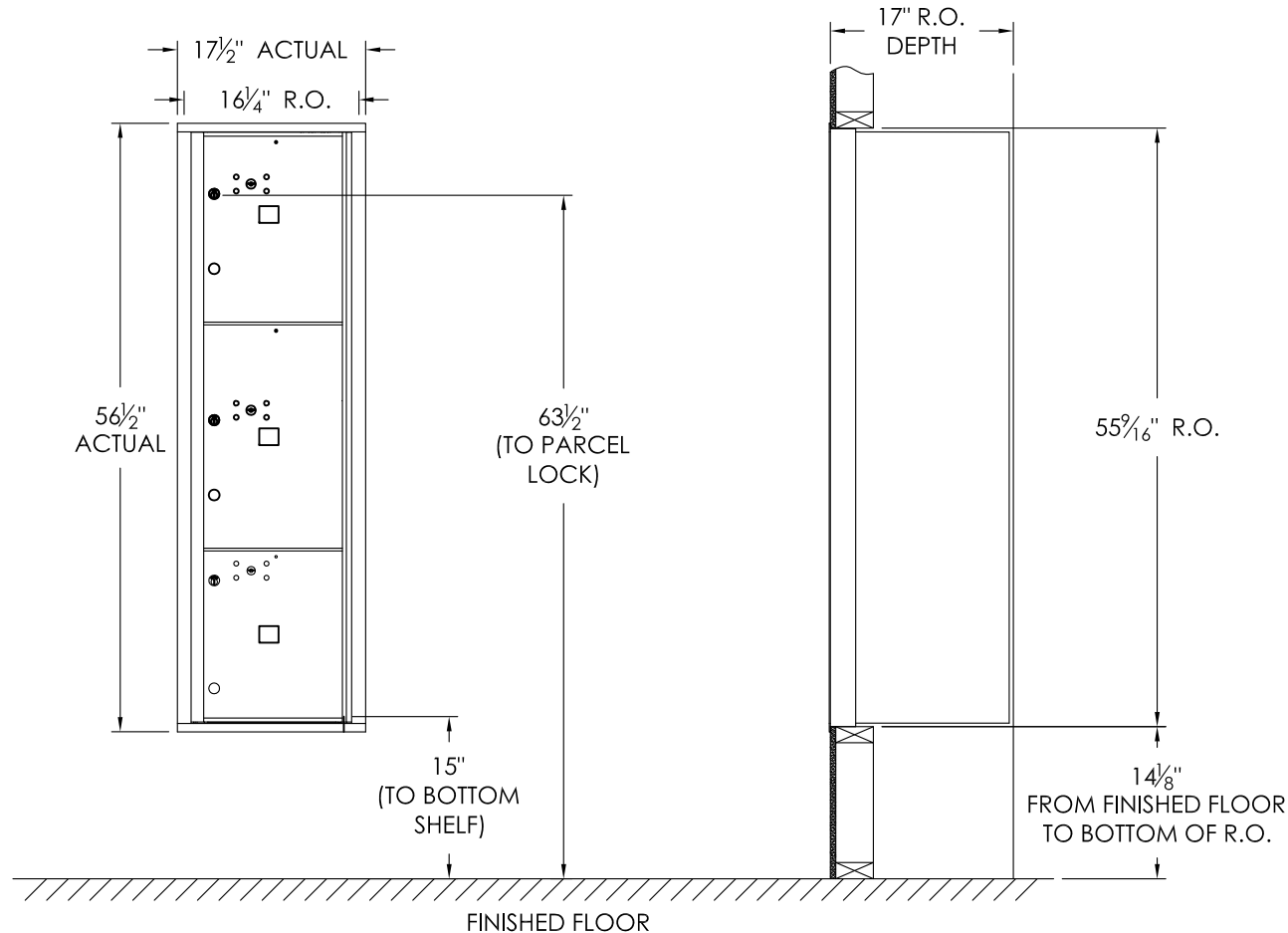

COMPARTMENT CHART

DESCRIPTION	COMPARTMENT	COMPARTMENT SIZE	QTY.
PARCEL LOCKER	PL15	15" H x 12" W x 15" D	1
PARCEL LOCKER	PL5	17" H x 12" W x 15" D	1
PARCEL LOCKER	PL6	20-1/2" H x 12" W x 15" D	1

## Notes:

- This module meets the USPS STD-4C requirements for installation defined below when the mailbox is installed per the dimensions provided on this drawing.
  - At least one customer compartment shall be positioned less than 48" above finished floor (AFF).
  - No parcel locker (interior bottom shelf) shall be positioned less than 15" AFF.
  - No patron (tenant) lock shall be positioned more than 67" AFF.
  - No customer compartment (interior bottom shelf) shall be positioned less than 28" AFF.
  - The USPS Arrow lock shall be positioned 36"- 48" AFF.
- This 4C mailbox can also be used for private applications.
- The rough opening width for multi-unit 4C installations = (the sum of all actual unit widths) - 1 1/8".

PRODUCT SERIES:

VERSATILE™ 4C FRONT LOAD MAILBOX

**FLORENCE**  
**CORPORATION**

5935 Corporate Drive • Manhattan, KS 66503  
800 275 1747 • [www.florencemailboxes.com](http://www.florencemailboxes.com)

MODEL 4C16S-3P	REV C
SCALE NONE	LAST REV DATE 2/23/17
DRAWING NUMBER 4C16S-3PCS	DRAWN BY NBC